

Harrison Street, Walsall, WS3 3HN
Offers Over £130,000
Council Tax Band: A



NO CHAIN

We're pleased to present this 2-bedroom mid-terrace property located in Bloxwich, just a short walk away from Bloxwich Town Centre for all local amenities.

Whilst work does need performing on the property, it offers a lot of great potential!

The property offers 2 good sized lounge areas, a kitchen, followed by a downstairs bathroom, upstairs you'll find 2 bedrooms. There is a rear garden that also has a lot of potential.

Council Tax Rating - A

EPC rating and Floorplans with measurement will be available soon.

Call to book in a viewing now!

125 Harrison Street
Approx. 44.8 sq. metres (482.2 sq. feet)

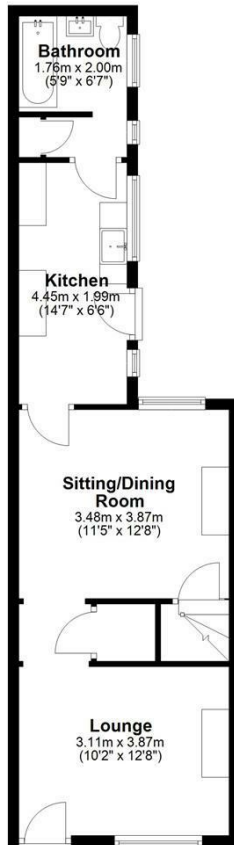

First Floor
Approx. 29.8 sq. metres (321.2 sq. feet)

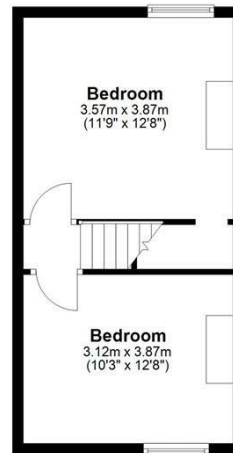

Total area: approx. 74.6 sq. metres (803.4 sq. feet)



Open House Bloxwich

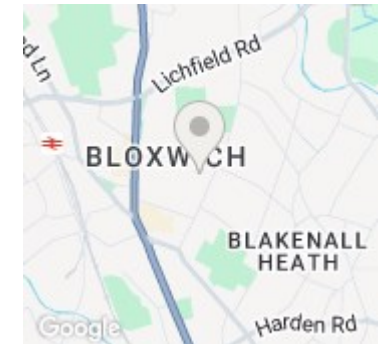

Energy Efficiency Rating		
	Current	Potential
Very energy efficient - lower running costs		
(92 plus) A		
(81-91) B		
(69-80) C		
(55-68) D		
(39-54) E		
(21-38) F		
(1-20) G		
Not energy efficient - higher running costs		
		77
	45	
England & Wales	EU Directive 2002/91/EC	